

nickelodeon



# Instruction Manual

## PAW Patrol Learning Phone



©2022 & TM Spin Master Ltd. All rights reserved.

**VTech understands that a child's needs and abilities change as they grow and with that in mind we develop our toys to teach and entertain at just the right level...**

## **vtech** Baby

**Toys that will stimulate their interest in different textures, sounds and colours**

### **I am...**

...responding to colours, sounds and textures

...understanding cause and effect

...learning to touch, reach, grasp, sit-up, crawl and toddle

*Birth-36 months*



## **Pre-School**

**Interactive toys to develop their imagination and encourage language development**

### **I want...**

...to get ready for school by starting to learn the alphabet and counting

...my learning to be as fun, easy and exciting as can be

...to show my creativity with drawing and music so my whole brain develops

*3-6 years*



## **Electronic Learning Computers**

**Cool, aspirational and inspiring computers for curriculum related learning**

### **I need...**

...challenging activities that can keep pace with my growing mind

...intelligent technology that adapts to my level of learning

...National Curriculum based content to support what I'm learning at school

*4-10 years*



To learn more about this and other VTech® products, visit [www.vtech.co.uk](http://www.vtech.co.uk)

# INTRODUCTION

Thank you for purchasing the **PAW Patrol Learning Phone**. Virtual chat with Chase and Skye with this interactive role-play phone! The PAW Patrol Learning Phone includes six exciting activities and features that introduce counting, maths, typing, matching and more. You can also receive fun voice messages from Chase, Marshall and Skye, and use voice-activated play to make pretend phone calls!



# INCLUDED IN THE PACKAGE

- PAW Patrol Learning Phone
- Quick Start Guide

## WARNING

All packing materials such as tape, plastic sheets, packaging locks, removable tags, cable ties, cords and packaging screws are not part of this toy, and should be discarded for your child's safety.

## NOTE

Please save this Instruction Manual as it contains important information.

## Removing the Packaging Locks

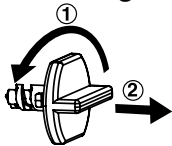

- ① Turn the packaging locks anticlockwise several times.
- ② Pull out and discard the packaging locks.

# INSTRUCTIONS

## Battery Removal and Installation

1. Make sure the unit is turned **OFF**.
2. Locate the battery cover on the back of the unit. Use a screwdriver to loosen the screw.
3. If used batteries are present, remove these batteries from the unit by pulling up on one end of each battery.
4. Install 2 new 'AAA' (AM-4/LR03) batteries following the diagram inside the battery box. (For best performance, alkaline batteries or fully charged Ni-MH rechargeable batteries are recommended).
5. Replace the battery cover and tighten the screw to secure.

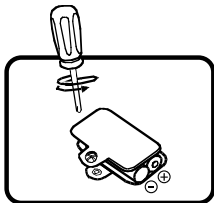

### **WARNING:**

Adult assembly required for battery installation.  
Keep batteries out of reach of children.

## **IMPORTANT: BATTERY INFORMATION**

- Insert batteries with the correct polarity (+ and -).
- Do not mix old and new batteries.
- Do not mix alkaline, standard (carbon-zinc) or rechargeable batteries.
- Only batteries of the same or equivalent type as recommended are to be used.
- Do not short-circuit the supply terminals.
- Remove batteries during long periods of non-use.
- Remove exhausted batteries from the toy.
- Dispose of batteries safely. Do not dispose of batteries in fire.

## RECHARGEABLE BATTERIES:

- Remove rechargeable batteries from the toy before charging.
- Rechargeable batteries are only to be charged under adult supervision.
- Do not charge non-rechargeable batteries.

## Disposal of batteries and product



The crossed-out wheellie bin symbols on products and batteries, or on their respective packaging, indicates they must not be disposed of in domestic waste as they contain substances that can be damaging to the environment and human health.

The chemical symbols Hg, Cd or Pb, where marked, indicate that the battery contains more than the specified value of mercury (Hg), cadmium (Cd) or lead (Pb) set out in the Batteries and Accumulators Regulation.



The solid bar indicates that the product was placed on the market after 13th August, 2005.

Help protect the environment by disposing of your product or batteries responsibly.

VTech® cares for the planet.

Care for the environment and give your toy a second life by disposing of it at a small electricals collection point so all its materials can be recycled.

In the UK:

Visit [www.recyclenow.com](http://www.recyclenow.com) to see a list of collection points near you.

In Australia & New Zealand:

Check with your local council for kerbside collections.

# PRODUCT FEATURES

## 1. On/Off Button

To turn the unit **ON**, press the **On/Off Button**. Press the **On/Off Button** again to turn the unit **OFF**.

## 2. Character Buttons



Press the **Character Buttons** to hear about the PAW Patrol pups and view their fun animations.

## 3. Learning Game Buttons



Press the **Learning Game Buttons** to play one of the four learning games.

## 4. Settings Button

Press the **Settings Button** to turn background music on/off, adjust screen contrast, or select a ringtone.

## 5. Number Buttons



Press the **Number Buttons** to learn about numbers or to answer number-related questions.

## 6. Chat Button

Press the **Chat Button** to enter the **Let's Chat** activity. This activity uses the voice activation feature. The LED will light up when this feature is activated.

## 7. Enter Button

Press the **Enter Button** to confirm your choice.

## 8. Left and Right Buttons < >

Press the **Left** or **Right Button** to make a selection in activities or menus.

## 9. Phone Call Button

Press the **Phone Call Button** to make a pretend phone call. You will hear the phone ringing and will then be able to leave a virtual voice message.

## 10. Cancel Call Button

Press the **Cancel Call Button** at any time to exit the current activity.

## 11. Microphone

The **Microphone** is used for the voice activation feature. Be sure to keep the **Microphone** about 10-12cm from your mouth for best results.



## 12. Automatic Shut-Off

To preserve battery life, the **PAW Patrol Learning Phone** will automatically turn **Off** after several minutes of inactivity. The unit can be turned **On** again by pressing the **On/Off Button**. The unit will also automatically turn **Off** when the batteries are very low. A warning will be displayed on screen as a reminder to change the batteries.



# ACTIVITIES

## 1. Connect With Characters

Press the **Chase, Marshall and Skye Buttons** on the phone to hear a voice message from that character. Press the **Rocky, Rubble and Zuma Buttons** to see a fun animation of that character.



## 2. Counting Sheep

All of Farmer Al's sheep have gone missing from his pasture! Help Chase rescue all the missing sheep. Watch carefully and count how many sheep pass by. Press a **Number Button** to answer or press the **Left or Right Button** < > to choose, then press the **Enter Button**  to confirm.

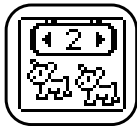

## 3. Fireworks Show

Chase found all the missing fireworks that had been delivered to the citizens of Adventure Bay, and now - the show must go on! Help Chase set off the fireworks by typing the number that appears on the screen as fast as you can. Press a **Number Button** to answer.

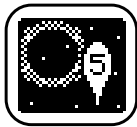

## 4. Matching Shadows

A mysterious ghost is causing havoc around the lookout at night. Remember the shadow, then choose the matching pose to find the ghost. Press the **Left or Right Button** < > to choose, then press the **Enter Button**  to confirm.

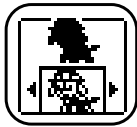

## 5. Number Quiz

Skye is on her way to Jake's Mountain to meet Everest and Ace, when a storm blows in and she crash lands in the snow. Get through the storm on Jakes Mountain by solving the equation. Press a **Number Button** to answer. Then blow into the **Microphone** to clear the clouds away.



## 6. Chat Button

Press the **Chat Button** on your phone to speed dial Chase or Skye. Once a pup answers, they will then ask you to tell them about yourself. Speak into the **Microphone** to answer.



# CARE & MAINTENANCE

1. Keep the unit clean by wiping it with a slightly damp cloth. Never use solvents or abrasives.
2. Keep the unit out of direct sunlight and away from any direct heat sources.
3. Remove the batteries if the unit will not be in use for an extended period of time.
4. Do not drop the unit on a hard surface and do not expose the unit to moisture or water.

# TROUBLESHOOTING

If for some reason the program/activity stops working, please follow these steps:

1. Turn the unit **OFF**.
2. Interrupt the power supply by removing the batteries.
3. Let the unit stand for a few minutes, then replace the batteries.
4. Turn the unit back **ON**. The unit should now be ready to use again.
5. If the unit still does not work, install a new set of batteries.

# CONSUMER SERVICES

Creating and developing VTech products is accompanied by a responsibility that we at **VTech®** take very seriously. We make every effort to ensure the accuracy of the information, which forms the value of our products. However, errors sometimes can occur. It is important for you to know that we stand behind our products and encourage you to call our Consumer Services Department with any problems and/or suggestions that you might have. A service representative will be happy to help you.

## **UK Customers:**

Phone: 0330 678 0149 (from UK) or +44 330 678 0149 (outside UK)

Website: [www.vtech.co.uk/support](http://www.vtech.co.uk/support)

## **Australian Customers:**

Phone: 1800 862 155

Website: [support.vtech.com.au](http://support.vtech.com.au)

## **NZ Customers:**

Phone: 0800 400 785

Website: [support.vtech.com.au](http://support.vtech.com.au)

# PRODUCT WARRANTY/ CONSUMER GUARANTEES

## **UK Customers:**

Read our complete warranty policy online at [vtech.co.uk/warranty](http://vtech.co.uk/warranty).

## **Australian Customers:**

VTECH ELECTRONICS (AUSTRALIA) PTY LIMITED –  
CONSUMER GUARANTEES

Under the Australian Consumer Law, a number of consumer guarantees apply to goods and services supplied by VTech Electronics (Australia) Pty Limited. Please refer to [vtech.com.au/consumerguarantees](http://vtech.com.au/consumerguarantees) for further information.

**Visit our website for more  
information about our products,  
downloads, resources and more.**

***[www.vtech.co.uk](http://www.vtech.co.uk)***  
***[www.vtech.com.au](http://www.vtech.com.au)***

